

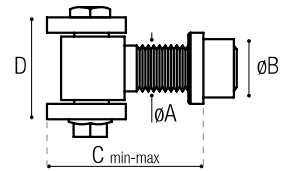

## Cardini superiori con alette e boccole a saldare

Upper hinges with wings and bushes to be welded  
Gonds supérieure avec ailettes et douille à souder  
Obere Torbänder mit Flügel und Buchse zum Schweißen

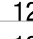

Cod.	øA	øB	C min-max	D		
199A	M16	24	42-63	40	12	
200A	M18	25	42-65	40	12	
205	M20	25	42-70	40	12	
222A	M22	28	50-75	50	6	
206	M24	30	50-80	50	6	
227A	M27	35	55-85	60	6	

## Cardini superiori con cavallotto e boccole a saldare

Upper hinges with bracket and bushes to be welded  
Gonds supérieure avec étrier et douille à souder  
Obere Torbänder mit Klemme und Lagerringe zum Schweißen

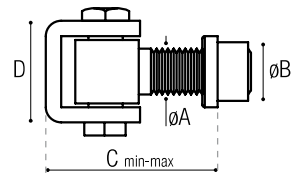

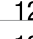
Cod.	øA	øB	C min-max	D		
699A	M16	21	42-63	40	12	
700A	M18	25	43-65	40	12	
705	M20	25	43-70	40	12	
722A	M22	28	50-75	48	6	
706	M24	30	50-80	48	6	

## Cardini superiori con alette e boccole regolabili

Upper hinges with wings and adjustable bushes  
Gonds supérieure avec ailettes et boîte réglable  
Umstellbare obere Torbänder mit Flügel und Buchse



Cod. 199R  
Cod. 200R  
Cod. 201MA

Cod. 222R  
Cod. 203MA  
Cod. 227R

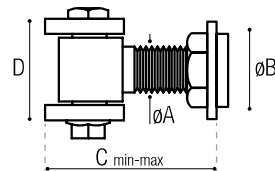

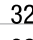
Cod.	øA	øB	C min-max	D		
199R	M16	32	42-63	40	32	12
200R	M18	32	42-65	40	32	12
201MA	M20	32	42-70	40	32	12
222R	M22	32	50-75	50	32	6
203MA	M24	40	50-80	50	41	6
227R	M27	40	55-85	60	41	6

## Cardini superiori con cavallotto e boccole regolabili

Upper hinges with bracket and adjustable bushes  
Gonds supérieure avec étrier et douille réglable  
Obere Torbänder mit Klemme und Lagerringe - regelbar



Cod. 699R  
Cod. 700R  
Cod. 705R

Cod. 722R  
Cod. 706R

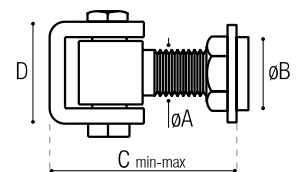

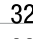
Cod.	øA	øB	C min-max	D		
699R	M16	32	43-63	40	32	12
700R	M18	32	43-65	40	32	12
705R	M20	32	43-70	40	32	12
722R	M22	32	50-75	48	32	6
706R	M24	40	50-80	48	41	6