

SCROCCO - LATCH BOLT



CARATTERISTICHE COSTRUTTIVE: Scatola e coperchio in acciaio zincato e plastificato - Frontale in acciaio inox - Scrocco anti-rumore in lega speciale nichelata - Ingegno maniglia in lega speciale zincata foro \varnothing 8 mm.

FUNZIONAMENTO: Scrocco comandato dalla maniglia.

MANO: Reversibile.

PARTI IN DOTAZIONE: /

CONSTRUCTIVE FEATURES: Zinc and plastic plated steel case and cover - Stainless steel forend - Nickel-plated special alloy anti-noise latch bolt - Zinc-plated special alloy square spindle device \varnothing 8 mm.

WORKING: Handle driven latch bolt.

HAND: Reversible.

PROVIDED WITH: /

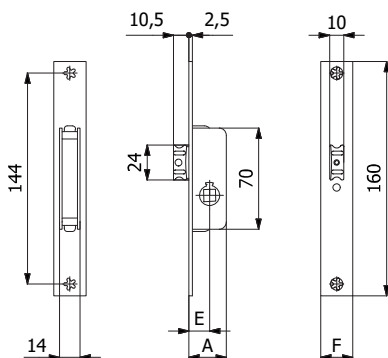

COD.	E	F	A			
351	15	16	26	0,15	2	20
351/F22	15	22	26	0,17	2	20

RULLO REGOLABILE - ADJUSTABLE ROLLER BOLT



CARATTERISTICHE COSTRUTTIVE: Scatola e coperchio in acciaio zincato e plastificato - Frontale in acciaio inox - Rullo in ottone nichelato.

FUNZIONAMENTO: Rullo comandato a pressione.

MANO: Unica.

PARTI IN DOTAZIONE: /

CONSTRUCTIVE FEATURES: Zinc and plastic plated steel case and cover - Stainless steel forend - Nickel-plated brass roller bolt.

WORKING: Pressure driven roller bolt.

HAND: No hand.

PROVIDED WITH: /

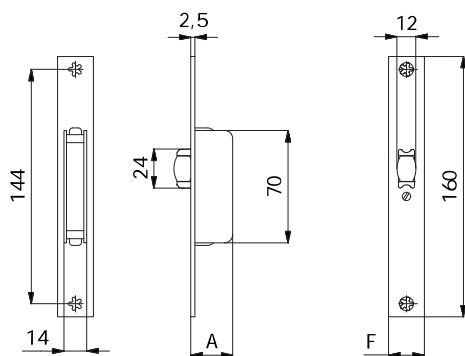

COD.	F	A			
345	16	26	0,14	2	20
345/F22	22	26	0,16	2	20